

OCEAN CITY'S "BAY CITY" REELS NOS. 175 AND 177
(Model c)

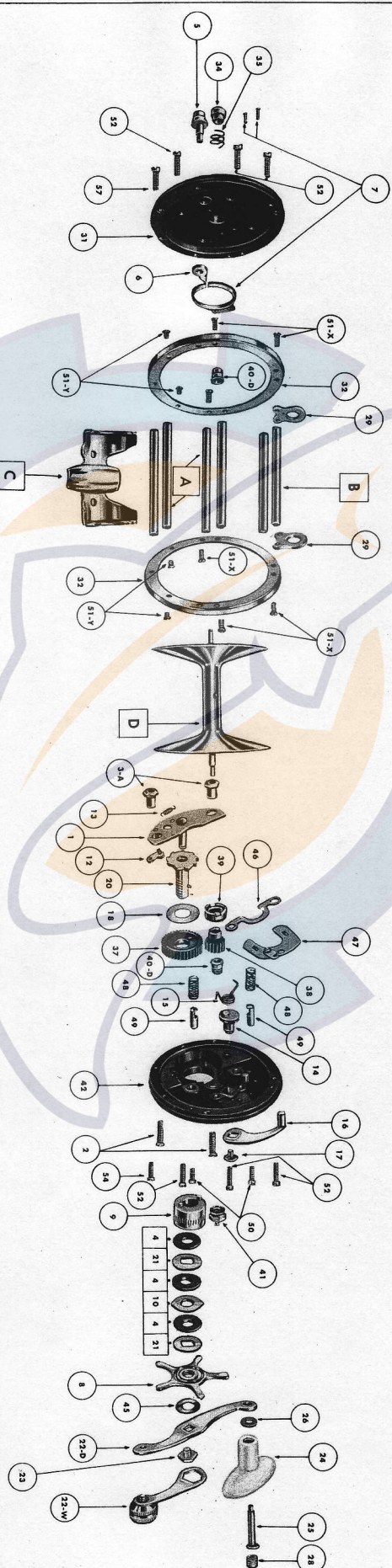

HOW TO ORDER PARTS FOR YOUR REEL—Locate the part desired in the illustration above and note part number. When ordering, state quantity, part number, part name and model letter which you will find on underside of reel stand. Enclose money order, stamps or check. Our minimum charge for one order is \$.25; please add \$.15 on each order for return postage and insurance.

PART No.	PART NAME	PRICE	PART No.	PART NAME	PRICE	PART No.	PART NAME	PRICE	PART No.	PART NAME	PRICE
1	Bridge	.50	16	Free Spool Lever	.25	26	Handle Knob Felt Washer	.01	41	Right Side Adjusting Cap	.12
2	Bridge Screw	.02	17	Free Spool Lever Screw	.08	28	Handle Knob Oiler	.24	42	Right Side Plate	1.00
3-A	Bridge Nut	.05	18	Fiber Drag Washer	.01	29	Harness Link	.24	43-	Stand (for Model No. 175)	1.00
4	Brake Lining Washer	.05	19	Frame Post (Model No. 175)	.14	30	Harness Post (for Model 175)	.10	43-A	Stand (for Model No. 177)	1.20
5	Click Button	.12	19-A	Frame Post (Model No. 177)	.16	31	Left Side Plate complete with Part Nos. 5, 6, and 7	1.30	44-Z	Spool (for Model No. 177)	5.00
6	Click Pawl	.12	20	Gear Sleeve and Lock Pin	.75	32	Left and Right Plate Ring	.50	45	Star Top Washer	.04
7	Click Spring and Rivets	.14	21	Gear Sleeve Lock Washer	.05	34	Left Side Adjusting Cap	.12	46	Yoke Plate	.20
8	Drag Star	.50	22	Handle Complete With Part Nos. 24, 25, 26, 28	1.50	35	Left Side Adjusting Cap Spring	.05	47	Yoke Spring	.40
9	Drag Cup	.70	23	Handle Screw	.16	37	Main Gear	.90	48	Yoke Guide Stud	.06
10	Drag Cup Lock Washer	.05	24	Handle Wrench	.50	38	Pinion Gear	.50	49	Yoke Guide Stud Screw	.02
12	Drag Dog	.10	25	Handle Knob Rivet	.06	39	Pinion Clutch	.25	50	Right and Left Inner Stand Screw	.02
13	Drag Dog Spring	.04				40-B	Right and Left Side Bearing	.30	51-X	Right and Left Inner Post Screw	.02
14	Eccentric	.75									
15	Eccentric Spring	.05									